

In the event of a malfunction of the phone, please contact Maxcom technical support or send the complaint to the seller.

Direct contact number: 32 325 07 00

## Mobile phone MM39D Brief User's Manual

**Caution:** The phone operates on the GSM 850/900/1800/1900 MHz WCDMA 900/2100 MHz network. LTE: 800/900/1800/2100/2600 MHz. Before switching on, the SIM card must be inserted correctly

### 1 INTRODUCTION

This User's Manual has been published by the producer. Revisions and corrections due to errors, inaccuracies in the current information and upgrades to the telephone or software may be made without prior notice, but will nevertheless be included in more recent versions of the User Manual. For further information and any assistance, please visit: [www.maxcom.pl](http://www.maxcom.pl). The producer reserves all rights to the contents of this manual.

Copyright and trademarks mentioned in this document remain the property of the respective owner. Copying, transmitting, storing or distributing all or part of the copyright material without prior written permission is prohibited.

### 2 SPECIFICATIONS

- Colour display: 2.0", 176x220pixels, TFT, SPI LCD
  - Large backlit keys with vibration function
  - Simple menu
  - Hands-free function
  - Phone book -2000 entries
  - Send and receive SMS and MMS function
  - M1/M2 memory, speed dialing (2-9)
    - FM radio, audio file player (MP3 / MIDI /AMR)
  - Alarm clock, Calendar, Dictaphone, Calculator
  - Flashlight
  - Memory RAM + ROM: 48MB+128MB
  - MicroSD card support: up to 32GB
  - SIM card :Nano SIM
  - Rechargeable battery: 1000 mAh
  - Standby time:160- 170h\*
  - Talk time: 4,5- 6,5h\*
  - Handset weight with battery:89g
  - Dimensions:47.2x145x14mm
- \*depending on conditions and GSM network signal

### 3 CONTENTS OF THE SET

- Mobile phone
- Mobile phone charger
- Charging station
- USB cable
- Rechargeable battery
- Brief user's manual
- Warranty card

**Caution:** It is advisable to keep the packaging, it may be helpful in case of a potential transport. Please keep your receipt, it is an integral part of the warranty.

### 4 ACCESSORIES

Only use rechargeable batteries, chargers and accessories recommended by the producer of this phone. Check which accessories are available from your retailer.

### 5 OPERATING AND SAFETY CONDITIONS

**Caution:** Familiarizing yourself with the following rules will minimize the risk of improper use of your phone.

- USAGE: The telephone emits electromagnetic fields which may adversely affect other electronic devices including, for example, medical equipment.
- Do not use the phone in restricted areas, e.g. hospitals, airplanes, petrol stations and near flammable materials. Using the phone in such areas may expose others to danger.
- Do not use your phone without the appropriate set while driving.
- Your device and its accessories may consist of small parts. Keep your phone and its components out of the reach of children.
- SERVICE: Do not carry out repairs or modifications yourself; any faults should be repaired by a qualified service centre.
- CLEANING: The phone must not be cleaned with chemicals or corrosive substances.
- FLASHLIGHT: Do not look directly into the light beam.
- HEARING AID: If you have a hearing aid, carefully adjust the volume of the phone and the sensitivity of the hearing aid accordingly.
- ELECTRONIC MEDICAL EQUIPMENT: your phone is a radio transmitter which may interfere with electronic medical equipment or implants such as hearing aids, pacemakers, insulin pumps etc. A minimum distance of 15 cm between the phone and the implant is recommended. You can seek advice on this from your doctor or the producer of such equipment.

- ELECTRONIC EQUIPMENT: To avoid the risk of demagnetisation, do not allow electrical equipment to be near your phone for long periods of time.

- WATERPROOF: The phone is not waterproof. Keep it in a dry place.

- DUSTFREE: the phone is not dustproof, do not use the phone in a dusty environment.

- DISPLAY: avoid pressing too hard on the LCD display or using sharp tools as this may damage it.

- Do not short-circuit the battery terminals with metal objects, as there is a risk of explosion.

- Do not expose the device to low or high temperatures, direct sunlight or high humidity. Do not place the device in the vicinity of heating installations e.g. radiator, heater, oven, central heating cooker, campfire, barbecue, etc.

- Protect your hearing!

Prolonged contact with loud sounds can lead to hearing damage. Listen to music at a moderate level and do not hold the device close to your ear when using the loudspeaker.



### 6 WARRANTY CONDITIONS

The phone comes with a warranty, of which the purchase receipt is an integral part. Damage resulting from improper use, electrostatic discharge or lightning strikes will not be repaired free of charge under the Warranty. If the user attempts to repair or modify the product himself, this voids the warranty! The above information is provided for information purposes.

### 7 DISPLAY DESCRIPTION

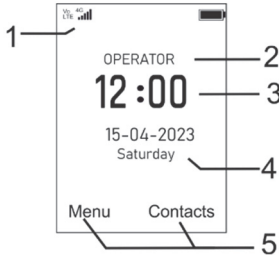

1. icons showing functions (table below).
2. Operator name.
3. Time.
4. Date.
5. description of the function keys.

	Network signal		No SIM card/SIM card error
	No service available		No signal/
<b>VoLTE</b>	VoLTE service active	<b>4G</b>	LTE range
<b>3G/ G</b>	3G/2G coverage		Flight mode
	New SMS / MMS		Missed call
	Vibration only (meeting profile)		Mute
	Outdoor profile active	<b>R</b>	(silent profile)
	Alarm active		Roaming active
	Full battery		Call redirecting activated
Icons may vary depending on software version * Icon also appears in national roaming when the subscriber is using the network of a second operator		Icons <b>R</b> may vary depending on software version * Icon also appears in national roaming when the subscriber is using the network of a second operator	

### 8 PHONE DESCRIPTION

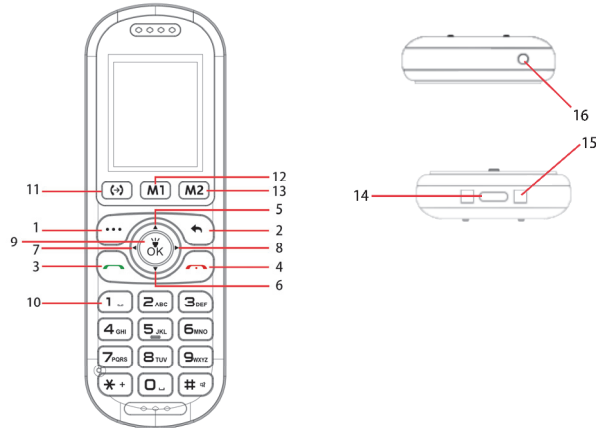

1		LKF(left function key)	Function as shown in the display
2		( right function key)	Function as shown in the display
3		Green handset (call key)	Short press: call connection; in standby mode enter call register;
4		Red handset (call termination key)	Short press: return to standby; end call. Long press: switch off/on the phone
5 6 7 8 9		<b>Navigation key</b> up down left right OK	In Menu : Press UP/DOWN LEFT/RIGHT to scroll through options or functions; switch settings. Press OK to select the highlighted item. In Standby: - UP/DOWN-set volume; LEFT - shortcut to memory number setting M1, M2; RIGHT - shortcut to AUDIO player; OK - main menu Hold OK to switch the flashlight on/off. During a call, press OK to enable/disable the hands-free function
10	<b>Numeric keys</b>		1-Short press: digit 1 Hold: voice mail 2 to 9Short press: entry of corresponding digit Hold: dialling the programmed speed dial number *Character input: *, +, P, W. When texting: special characters #Short press : change the input mode while texting; in standby mode enter #
11		Call transfer button	During the call, select from Add new call, enter the number and press the green handset. Once the new number is connected, press  to transfer the call.
12 13	<b>Memory M1</b> <b>Memory M2</b>		Hold: dials the programmed speed dial number
14	USB C socket for the power charger		
15	Charging contacts for charging station		
16	Flashlight diode		

**Caution:** In order to save energy, the display automatically goes to sleep after a certain period of time. To activate the display backlight, press the left function key.

### 9 PHONE PREPARATION

#### 9.1 INSTALLATION OF SIM CARD, SD CARD AND BATTERY

The phone supports the nano SIM card (4FF). Using other SIM cards may damage the card or the phone. You will receive a SIM card from your service provider. Keep the SIM card out of the reach of children. Any abrasion or bending can easily damage the SIM card, so take extra care when inserting, removing and storing it.

**Caution:** do not insert or remove SIM cards if the phone is connected to a charger. Make sure the phone is switched off before removing the battery from the phone. Insert the SIM card into the slot so that its gold-plated connectors face down, optionally install a microSD memory card. See picture below:

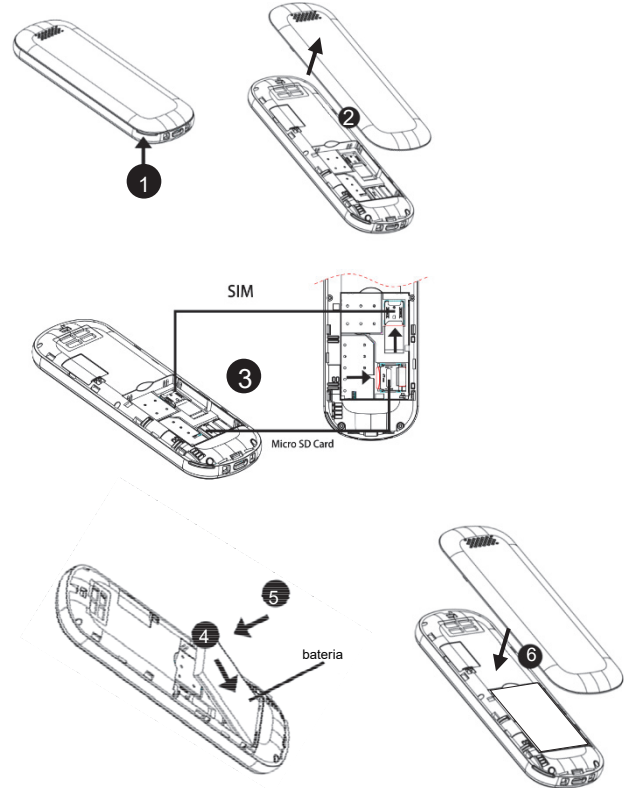

#### 9.2 CHARGING THE BATTERY



**Caution:** Use the rechargeable battery included in the set. Using another battery may damage the phone and will void the warranty. Do not connect the charger when the back cover of the case is removed. Aby naładować telefon: 1.Plug the charger into a mains socket.

2.Plug the charger plug into the socket on the bottom of the phone. The display will indicate that the charger is connected and the bars on the battery charge indicator on the display will appear and disappear as it is being charged.

3.When the battery is fully charged, disconnect the charger from the power socket and then the cable from the phone.

When the charging process is complete, the display will briefly show "Battery charged" and the battery symbol will not flash when illuminated.

Caution:

Before starting the charging process, ensure that the battery is properly installed

Do not remove the battery during the charging process - you may damage the phone

If the battery voltage is too low for the phone to function properly, a message will be displayed that the phone will be automatically switched off.

If the battery is completely discharged, wait several minutes after connecting the charger before the charging symbol appears.

If you have not used the phone for a long time, the battery may be in a state of so-called "deep discharge"; to restore proper operation, leave the charger connected even though nothing appears on the display. This can take up to an hour.

When using a charging station, first plug the small plug of the mains charger into the socket of the charging station and then plug the power supply into the mains. To charge the battery, simply then insert the phone into the charging station with the contacts facing down.

Caution. The power socket must be close to the device and easily accessible.

### 9.3 SECURITY CODES

#### 9.3.1 PIN CODE

This is your SIM card's private identification code and is supplied by your operator.

The PIN2 code is supplied by the operator with the SIM cards.

Some SIM cards do not support this code.

If you enter the incorrect PIN code 3 times in a row, the SIM card will be locked. It can be unlocked using the PUK code. Entering the PUK code incorrectly 10 times will lock the SIM card.

Please contact your network operator for more information.

#### 9.3.2 PHONE LOCKING

The phone lock code prevents others from using your phone without authorisation (the original phone code is 1122).

To protect your personal information, change the original phone code.

With the phone code it is possible to block others from using selected settings on your phone.

### 10 PHONE USAGE

#### 11 TEXT INPUT

To type text, press the corresponding key until the desired letter is displayed.

Space - press the 0 key.

Full stop, comma and other characters-press the 1 key several times.

To type a symbol or special character, press .

To type a number press and hold the number key.

To change the text entry method press the "#" key

#### 11.1 SWITCHING THE PHONE ON/OFF

Press and hold the red handset key to switch the phone on or off.

1. the display will show a field to enter the phone code and PIN code (if security is enabled). After entering the phone code and PIN, the phone will enter M standby mode.

If you make a mistake when entering the PIN and phone code, you can delete the characters by pressing PKF (right function key).

When switched on, the phone automatically searches for a network

If the phone detects an authorised network, the name of the network and the signal level will appear on the screen. If a network is not found, you can only make emergency calls or use non-communication functions.

#### 11.2 MAKING CALLS

In standby mode, type in the telephone number you wish to call.

Press the right function key "Delete" to delete the incorrect data entered.

Once you have entered the correct number, press the call key.

1. Dialing extensions.

Some extensions cannot be called directly and it is necessary, first, to connect to the telephone exchange or trunk and then dial the extension number.

2 Making an international call. For international calls, it is required to enter "00" or "+" before the number. To enter "+" use the "" key.

3.Dialing a number from the phone book.

Go to Contacts via the menu, use the Up/Down navigation keys to find the contact or enter the part of the name you are looking for. Press the make call key..

4. Dialing from call history.

Enter the Call log (press the Call key in standby mode or enter via the menu), use the Up/Down navigation keys to select the desired contact. Press Right/Left to navigate between missed, dialed, answered and rejected numbers

5 Easy dialling

If you have previously assigned contacts to keys M1,M2,2-9 in standby, press and hold the corresponding key to make a call

#### 11.3 RECEIVING CALLS

In the event of an incoming call, the phone will notify you with an appropriate signal, if your network accepts caller ID, the caller's name or number will be displayed on the screen (depending on whether the caller's information is in the phonebook).

1. press the call key or the left function key to answer an incoming call.

If the recording option is selected in (Settings ->Calls ->Other ->Automatic call recording), the conversation will be recorded when the call is answered.

If you do not want to answer an incoming call, press the end call key. To mute the call, press the centre function key.

4. During a call, select Menu to access contacts, messages, call log, put a call on hold, mute a call, add a new call or start recording. Press the middle function key to enable/disable hands-free mode. Use the Up/Down keys to adjust the call volume.

#### 11.4 CALL TRANSFER

This is a network service that must be activated with your operator. During a call, press the left function key (LKF) and select New call, enter the number and press the green handset. Once the new call has been established, press the button  (call forward button) and the call will be redirected.

#### 11.5 KEYPAD LOCK

To lock the keypad press the left function key and then the "" key. If the automatic keypad lock is activated(MENU>Settings>Security>Auto keypad lock), the phone will automatically lock the keypad after the set time has elapsed. To unlock the keypad press the left function key and then "".

#### 11.6 EMERGENCY NUMBER

You can directly dial the 112 emergency service without a SIM card. 112 is the European emergency number

### 12 SAVING CONTACTS

In standby mode, select the desired number ( or select from the call list )>Press Options > Add to Contacts, select if this should be a new contact or an already saved contact, then select memory (Phone or SIM) >OK>Press the centre OK key to edit the field> press PKF, then OK to save the contact

### 13 MEMORY M1/M2

Press the key to the Left , or in the MENU select: Settings>M1/M2

Import the contact you wish to assign to the M1 button or enter the name and number and press OK.

Follow the same procedure when saving the M2 button

### 14 SIMPLE DIALING

To assign a number to a key, from the MENU select: Contacts>Options>Other>Fast Dial.

Then select which key you want to assign the number to. Enter the number or select from the contact list and press OK.

### 15 SMS AND MMS MESSAGES

Your phone allows you to send and receive SMS text messages and multimedia MMS. When the icon  is displayed on the screen, it means that there is at least one unread message.

To enter the SMS Messages MENU, select Menu>Messages>Inbox in standby mode. When the inbox is full, a message will appear that the message memory is full. Delete messages from the inbox to resolve the problem.

#### 15.1 WRITING AND SENDING MESSAGES

1. In the Menu, select Messages

2. Select New SMS/New MMS

3. Add a contact from the phonebook or enter the desired number

4. Press the DOWN key to go to Message Entry, type your message.

5. Press the Options>Send key

If you want to send a message to several people, while typing the number, add the next number after the semicolon or add the numbers stored in the phonebook.

To save the message, press Options>Save as draft (the message will be saved in Draft). Draft (the message will be saved in the Drafts folder).

Press Options>Add to insert information about a contact saved in the phonebook, - add an emoticon, insert a template, etc.

#### 15.2 READING AND RESPONDING

When the display shows the unread message icon or you want to read received messages, in MENU select: Messages>Inbox>Search for desired message press the centre OK key to read the message

- press the OK centre key to reply via SMS/MMS
- press the call key to call the sender
- to delete, add sender to phonebook, add to blacklist, etc., press Options and select appropriate item.

#### 15.3 MESSAGE SETTINGS

Go to MENU and select: Messages> Settings,

You can adjust the validity of messages, on/off delivery reports, on/off saving of sent messages and choose where to save messages.

### 16 VOCIEMAIL

Voicemail is an operator service that allows us to leave voice recordings when someone fails to call us. To find out more, contact your operator. You can get a voicemail number from your service provider. You need to dial the number: Menu ->Messages ->Voicemail Server, then enter the voicemail number. When you hold down the 1 key on the keypad, in standby, the voicemail will start.

### 17 LANGUAGE

MENU>Settings>Telephone>Menu language

Allows you to change the phone's menu language. If you accidentally set a foreign language, to change to the correct one, in standby press OK :

- 1x UP>OK
- 2x DOWN>OK
- 1x DOWN>OK

- OK , select the correct language and press OK.

#### 17.1.1BLACK LIST

MENU ->Settings ->Security ->Blacklist

When this option is active and numbers are added to the blacklist, the phone automatically rejects incoming calls and/or SMS from the numbers on the list

### 18 RECHARGEABLE BATTERY INFORMATION

The phone includes a rechargeable battery, which can be recharged using the charger included in the set.

The operating time of the phone depends on various operating conditions. The shorter working time is significantly affected by how far you are from the relay station and the length and number of calls you make. When moving, the phone constantly switches between relay stations, which also has a significant impact on the operating time.

The battery naturally loses its properties after several hundred charges and discharges. If the user observes a significant loss of performance, a new battery should be obtained.

Only use the batteries recommended by the producer. Do not leave the charger connected for more than 2-3 days.

Caution: do not keep the phone in areas of excessive heat. This can have a negative impact on the battery as well as the phone itself.

Never use a battery with visible damage. This can lead to a short circuit and damage to the phone. Insert the battery in accordance with the polarity.

Leaving the battery pack in areas of excessive heat or cold will reduce its service life. Store the battery pack at a temperature between 15°C and 25°C. If a cold battery is inserted into the phone, the phone may not work properly and there is a risk of damage.

### 19 ENVIRONMENTAL INFORMATION

Caution: this device is marked in accordance with the European Directive 2012/19/EU and the Polish Act on Waste Electrical and Electronic Equipment with the crossed-out wheeled bin symbol.



Such labelling indicates that this equipment, after its use, must not be placed together with other household waste.

Caution: this equipment must not be disposed of in municipal waste!!! The product must be disposed of by selective collection at a dedicated collection point.

Proper handling of waste electrical and electronic equipment contributes to avoiding harmful consequences for human health and the environment due to the presence of hazardous components and improper storage and treatment of such equipment.

In order to recycle the materials used for the phone's packaging, follow the rules for sorting materials established locally for this type of waste.

A Li-ion rechargeable battery is included. Used rechargeable batteries are harmful to the environment and should be disposed of at a designated point in a suitable container in accordance with current legislation. Batteries and rechargeable batteries must not be disposed of in municipal waste, they should be taken to a collection point. DO NOT DISPOSE OF BATTERIES OR RECHARGEABLE BATTERIES IN A FIRE!



### 20 SAR INFORMATION

This model complies with international guidelines for the impact of radio waves. This device is a radio wave transmitter and receiver. It is designed not to exceed the limits of radio wave exposure recommended by international guidelines. These guidelines have been established by the independent scientific organisation ICNIRP, taking into account a safety margin to guarantee the protection of all people regardless of age and health. These guidelines use a unit of measurement called Specific Absorption Rate (SAR). The SAR value is measured at the highest transmitting power, the actual figure when the device is operating is usually lower than the level indicated above. This is due to automatic variations in the power level of the device to ensure that it uses only the minimum required to connect to the network.

Although there may be differences in SAR values for different phone models, and even for different positions of use, they all comply with the regulations for safe radiation levels.

The World Health Organisation said that current research has shown that there is no need for any special restrictions on the use of mobile devices. It also points out that if you want to reduce the impact of radiation, you should limit the length of your conversations or use a headset or speakerphone when talking to avoid holding the phone close to your body or head.

Highest measured SAR value in tests		Limit(W/Kg)
SAR value - device at head	0.446 W/kg 10g	2.0 W/kg
SAR value- device at the back	1.233 W/kg 10g	2.0 W/kg
SAR value - device on limb	2.097 W/kg 10g	4.0 W/kg

SAR values may also vary depending on national reporting and testing requirements and the frequency band of the network in question

### 20.1 FREQUENCY RANGE AND MAXIMUM POWER OF THE DEVICE

System	Frequency range	Maximum emitted power
GSM 900	880 -915 MHz	32.11 dBm
GSM1800	1710-1785 MHz	30.16 dBm
WCDMA Band I	1920-1980 MHz	23.37 dBm
WCDMA Band VIII	880- 915 MHz	21.86 dBm
LTE Band 1	1920-1980 MHz	23.29 dBm
LTE Band 3	1710-1785 MHz	22.26 dBm
LTE Band 7	2500-2570 MHz	22.79 dBm
LTE Band 8	880- 915 MHz	22.78 dBm
LTE Band 20	832- 862 MHz	22.86 dBm
Short range communication	2402-2480 MHz	9.16 dBm EIRP
Radio FM	87.5MHz -108MHz	-

### 20.2 CHARGER

The external power supply for the phone complies with Commission Regulation (EU) 2019/1782

Model identifier	MM36D, DYK-0051000
Input voltage	AC 100-240V
Input AC frequency	50/60Hz
Output voltage	DC 5.0V
Output current	1A
Output power	5 W
Average efficiency during operation	73.64%
Efficiency at low load (10 %)	-
No-load power consumption	0.1W

### 21 UE SIMPLIFIED EU DECLARATION OF CONFORMITY

Maxcom S.A. hereby declares that the radio device type: MAXCOM mobile phone MAXCOM MM39D complies with Directive 2014/53/EU, and Directive 2011/65/EU (RoHS).

The full text of the EU Declaration of Conformity is available at the following web address: <http://www.maxcom.pl/deklaracja>

**Caution:** This manual is intended for information purposes only. Some of the functions and options described may vary depending on the software and country.

If technical assistance is required, we recommend contacting the technical department at 32 325 07 00 or email [serwis@maxcom.pl](mailto:serwis@maxcom.pl)

Our website: <http://www.maxcom.pl/>

The proper operating conditions of the phone as well as the battery depend on the local network environment, the SIM card, and the use of the phone.

The producer does not accept any responsibility for consequences caused by incorrect use, abuse or non-compliance with the instructions.

The producer reserves the right to change or make changes without prior notice.

**MAXCOM S.A.**  
**Towarowa Street 23a**  
**43-100 Tychy**  
**tel.: 32 327 70 89**  
**www.maxcom.pl**  
**e-mail: office@maxcom.pl**

